

BA9x Family: BA92, BA93 and BA93W

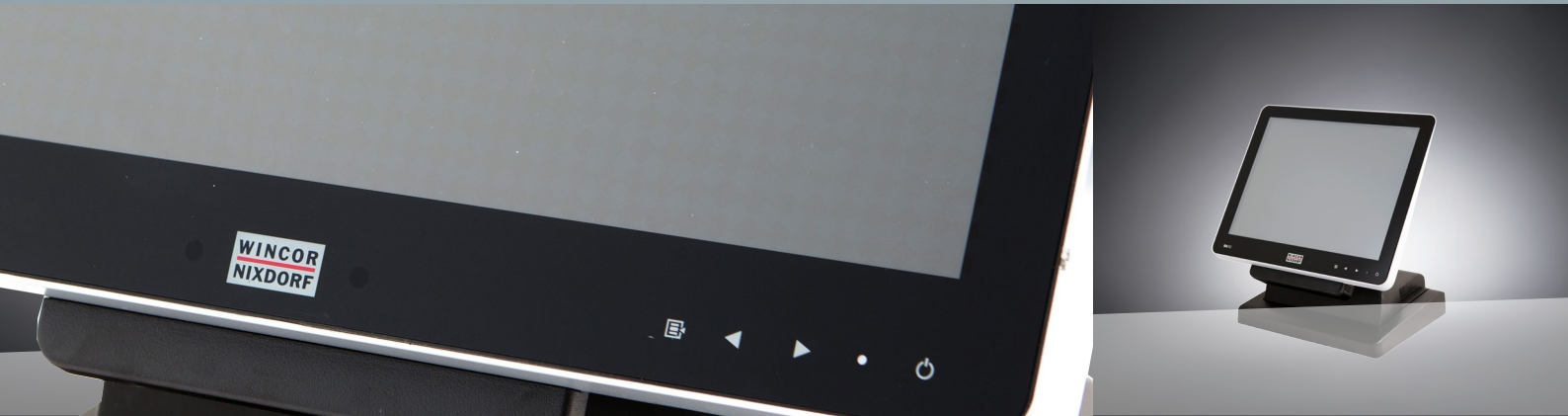

POS touch-screen Bezel free and Robust

The BA9x (BA92, BA93 and BA93W) is the new touch-screen generation developed by Wincor Nixdorf. These screens are the result of decades of experience and expertise in developing POS solutions combined with an empathic listening and understanding of the market requests and constant innovation.

Touch-screen technology and the innovations that enhance a user's interaction with their data have rapidly increased in popularity and are being deployed as 'the norm' by many businesses.

Multi-touch capabilities and intuitive interfaces open the door to higher levels of efficiency and brand perception by customers.

Equipped with a robust aluminum housing and a sleek modern bezel-free design, the BA9x family allows the use of multi-touch applications with projected capacitive touch.

Design

The BA9x touchscreen family is versatile and can be used with EPOS terminals or as interactive kiosk/touch point. Its elegant, slim design and graphical user interface

creates an attractive addition to stylish & modern checkout lanes.

The bezel-free design gives the displays the look and feel of modern smartphones or tablets and makes them easy to maintain and clean. The BA9x displays feature an anti-glare surface to reduce light reflections and improve readability.

Interfaces

The BA9x family features the unique Wincor Nixdorf Panellink2™ interface. This allows for operation of the displays via a single cable solution. In addition, the display can also be used with the standard PoweredUSB, DVI and VGA cables common to the POS environment. Use of an external power supply is also possible thanks to a 12V DC connector. In this case, the data transfer is done by a USB A-B cable.

Peripherals

The BA9x touch screen suite has an integrated USB hub and outlets on each side of the screen, allowing for the easy and quick installation of valuable peripherals such as a Magnetic Stripe Reader (MSR) or Waiter lock (iButton) eliminating the need for further cabling.

Screen features

The screens are equipped with a TFT Panel with LED backlight which produces perfect readable user interfaces under all light conditions.

BA92 BA93 and BA93W feature projected capacitive technology (10 points multi-touch supported). There is also a version equipped with resistive touch technology and a non-Touch version available for BA92 and BA93, allowing the screens to be used either as operator or customer display.

All BA9x are equipped with Ambient Light Sensor (ALS) and Presence Sensor to reduce the power consumption.

The wide format 16:9 screen of the BA93W combined with its excellent colour quality and brightness is the perfect solution for commercials and promotional videos.



WINCOR
NIXDORF



Services

Wincor Nixdorf's fast, professional manufacturer service is available as an option for the BAx family as part of the complete solution offer. Tailored services enable the highest possible system availability and security worldwide due to standardized service processes and efficient remote management based on the Wincor Nixdorf eServices Platform®.

→

Implementation and power consumption

The BA92, BA93 and BA93W can be integrated into almost all point of sale systems due to its small footprint. The VESA-compatible mounting solution allows the screen to be used not only as a desk top model but also as a wall or pole-mounted system.

As a dual screen solution, it is possible to mount a second display (BA90 8", BA91W 10.1" or BA92 12.1") to the back of the main display with the help of a dual display adapter.

The low power consumption is compliant with EnergyStar standards helping reduce the environmental impact of the EPOS systems as well as the total costs of ownership.

TECHNICAL DATA

	BA92	BA93	BA93W
Screen size	12.1"	15"	15.6"
Weight in kg	w/o base	2.0	2.9
	With base	4.5	5.4
Resolution	800 x 600	1024 x 768	1360 x 768
Number of colors	16.7 Mio	16.7 Mio	16.7 Mio
Brightness (cd/m ²)	pc-Touch: 400	pc-Touch: 310	pc-Touch: 270
	r-Touch: 335	r-Touch: 260	r-Touch: 260
	non-Touch: 400	non-Touch: 310	non-Touch: 310
Contrast	800:1	800:1	500:1
Viewing angle (°)	80 / 80 (H)	80 / 80 (H)	85 / 85 (H)
	60 / 80 (V)	60 / 80 (V)	80 / 80 (V)
Format	4:3	4:3	16:9
Dimensions (mm)	292 x 257.9 x 47	349 x 308.5 x 47	395 x 271.2 x 51.2
Interface	PanelLink2™, DVI-D, VGA, USB-A, USB-B, Power-Jack	PanelLink2™, DVI-D, VGA, USB-A, USB-B, Power-Jack	PanelLink2™, DVI-D, VGA, USB-A, USB-B, Power-Jack
Options	Stand, Mounting Pole, VESA 100	Stand, Mounting Pole, VESA 100	Stand, Mounting Pole, VESA 100
Audio (USB)	Integrated 2W	Integrated 2W	Integrated 2W
Powerconsumption	Typical	9.9 W	12 W
	Standby	< 0.5 W	< 0.5 W
Operating temperature (°C)	5 to +40	5 to +40	5 to +40
Storage temperature (°C)	-20 bis +60	-20 bis +60	-20 bis +60

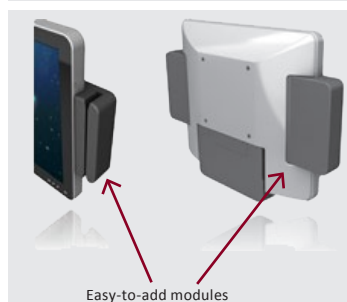
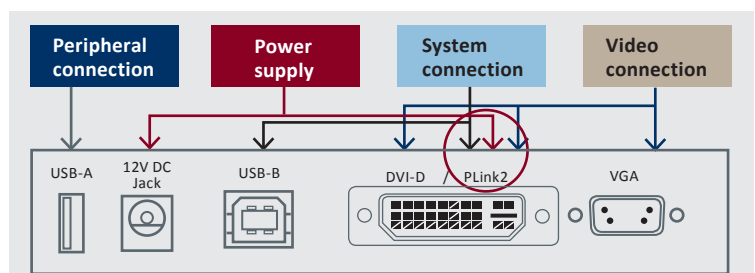

Published by
Wincor Nixdorf International GmbH
 Heinz-Nixdorf-Ring 1
 33106 Paderborn
 Germany
 Phone: +49 (0) 52 51 / 6 93-39 60
 Fax: +49 (0) 52 51 / 6 93-39 03
 info.retail@wincor-nixdorf.com
 www.wincor-nixdorf.com

© Wincor Nixdorf International GmbH

Printed in Germany, January 2015